

PERSPECTIVE 1

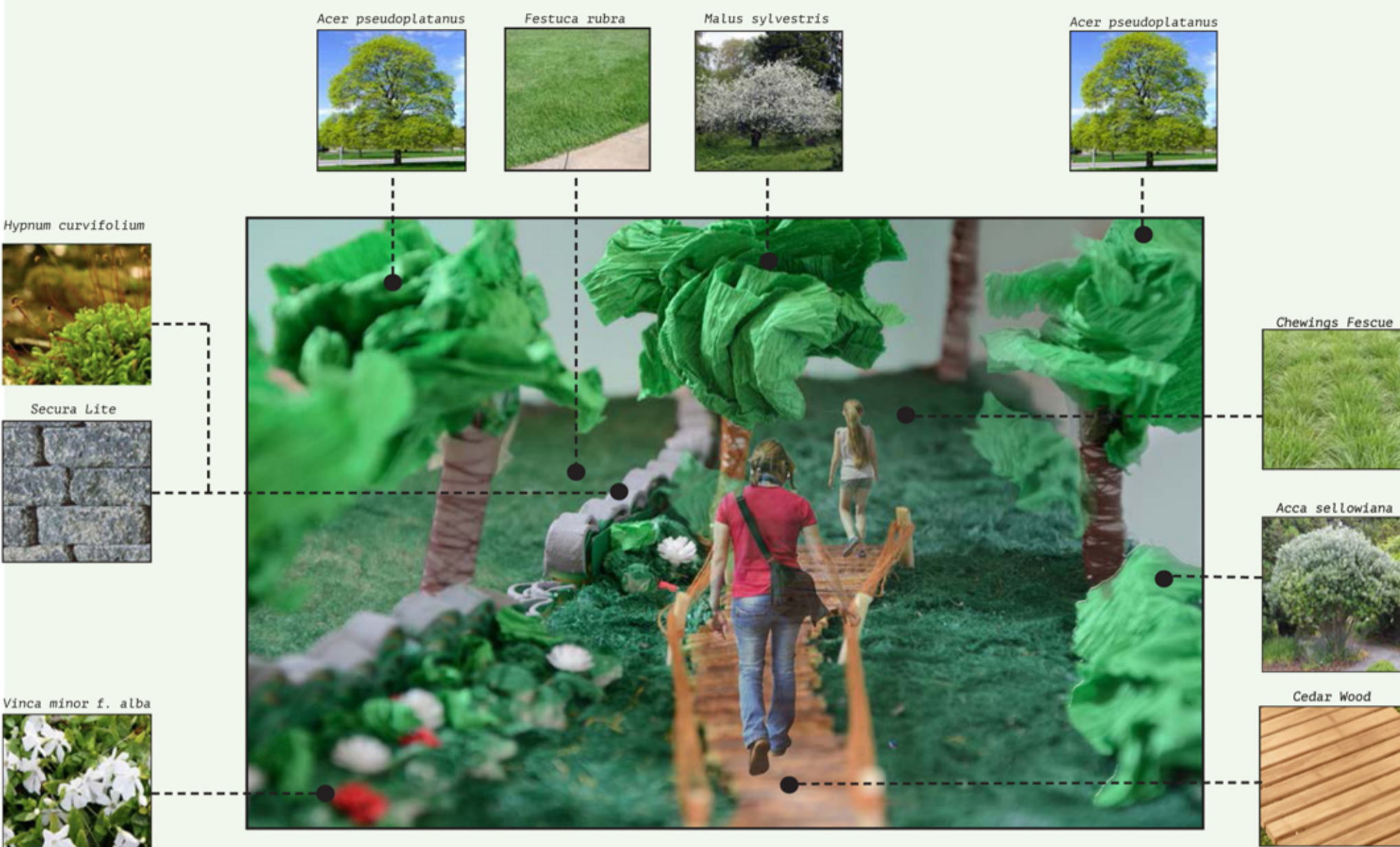

This perspective of the study model primarily shows the elevated strip which spans laterally across the edge of my significant moment. The inspiration behind this space was to create an urban oasis where human activity was limited to ensure both the plants and animal species present could flourish as naturally as possible. When people pass through this section, they will feel a sense of escapism from the surrounding urban environment and protection from the number of tree canopies overhead and will ultimately feel connected to nature. The bridge which runs through the middle of this section further adds another elevated element to the space, people are able to walk, enjoy and take in the peaceful atmosphere created specifically within this space.

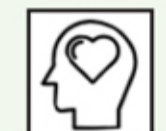

PERSPECTIVE 2



This perspective is showing the elevation in more detail, running along this section is a natural stone wall which creates a separation between the two spaces, however, by incorporating steps it connects both landscapes together allowing people to move throughout the space efficiently. The Festuca rubra on the ground layer is cut short to allow people to comfortably sit and connect with the landscape. The fragile wildflowers add colour to the space and the moss growing within the cracks of the wall transforms it into a living habitat. My main aim was to create a simple space where both plants and animals can thrive, whilst people are able to respect the natural landscape and use and enjoy it accordingly.

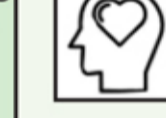

PERSPECTIVE 3



This photograph shows the perspective of the left hand side of the wall. Stepping down from the bridge is an area of less restricted movement - people can explore their own walking routes by not following any particular pathway. The species of trees within this area have been specifically placed to attract a range of bird species to increase biodiversity in the area and to stimulate people as they walk throughout the space. On the ground level, is a free space designed with minimal planting to allow people to carry out physical activities such as exercise. Large green spaces are important for both physical and mental wellbeing and this is what I want to capture within this particular area. Also, the photograph shows a wall partition which divides the landscape between an open green space and a quiet seating area. There is also a water feature running alongside this wall which incorporates the River Aire into this landscape.

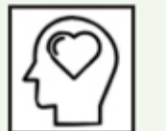

PERSPECTIVE 4



This photograph shows the perspective of the raised green corridor from the opposite angle to perspective one, at the point the wooden bridge ends, there is a small step down to create another level within the landscape - this adds dimension to the space. The trees located within this area attract pollinating insects and a range of birds which will add to the sensory experience felt when moving through this space. The stone wall running alongside this section creates a partitioning between the two spaces, however people are still able to see over the wall to ensure the space doesn't feel enclosed and segregated. Chewings fescue is used as the groundcover, as this gives a more natural feel to the space - similar to the groundcover found in a more naturally occurring rural landscape.

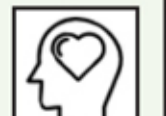

PERSPECTIVE 5

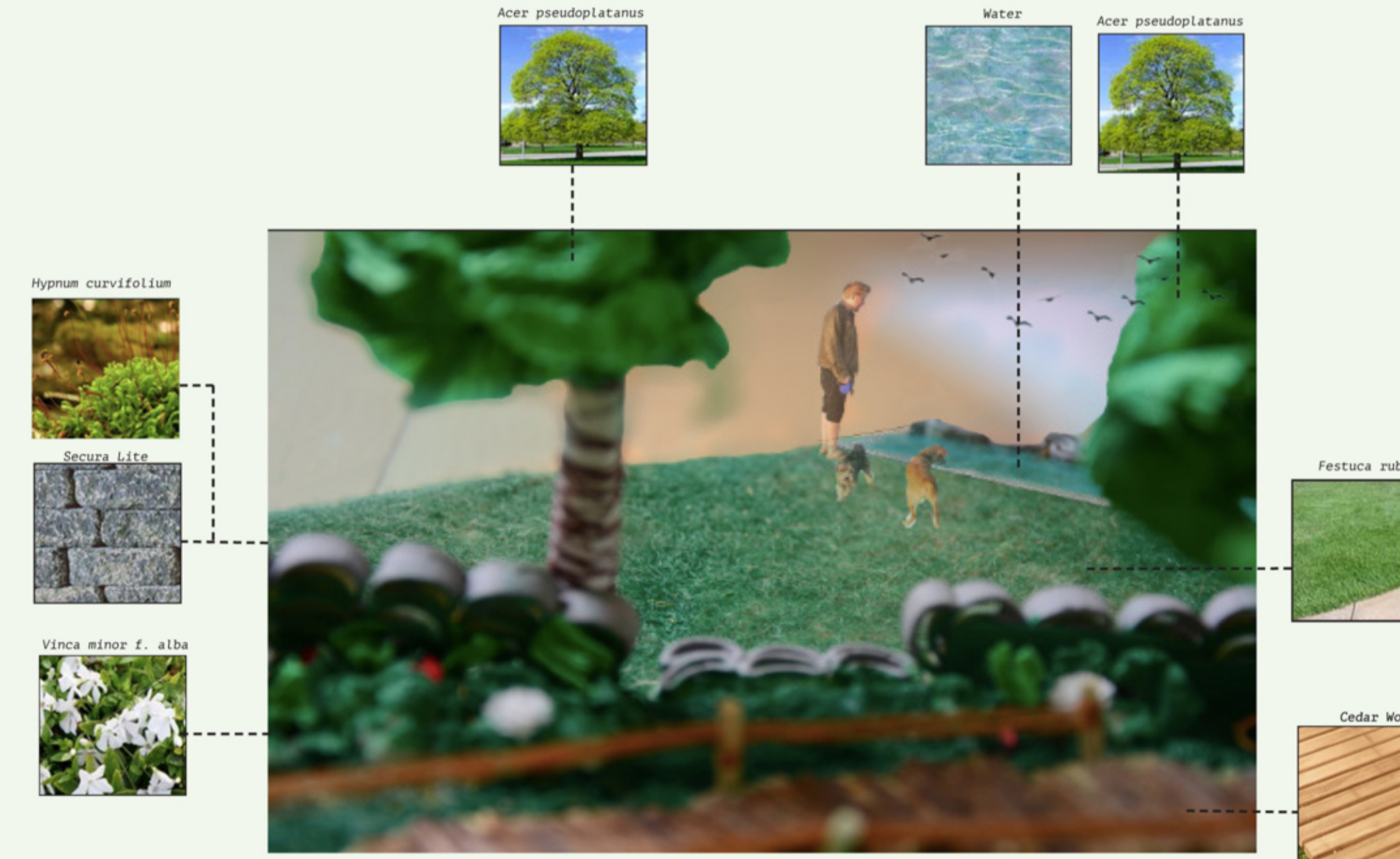

This photograph shows the perspective of the lower adult playing area from the view of the raised green corridor. The stone steps leading down to this space increase the efficiency of access between the two areas. The steps are comprised of the same stone material as the wall to ensure stability and to maintain a traditional and naturally worn aesthetic. Festuca rubra covers the majority of the lower ground level as this is a short and easily manageable grass which is highly practical for an area which will be used by people often. Also, the limited planting in this area will make it feel especially spacious compared to the raised level above. The water feature incorporates the river into the space and looks good aesthetically within the green landscape.



OVERALL MODEL PHOTOGRAPH



The overall model photograph shows the different levels within the landscape and how they differ from each other. The softscape and hardscape materials used are practical, aesthetically pleasing and work together to create a cohesive landscape.

